

# *Matilda*® 23

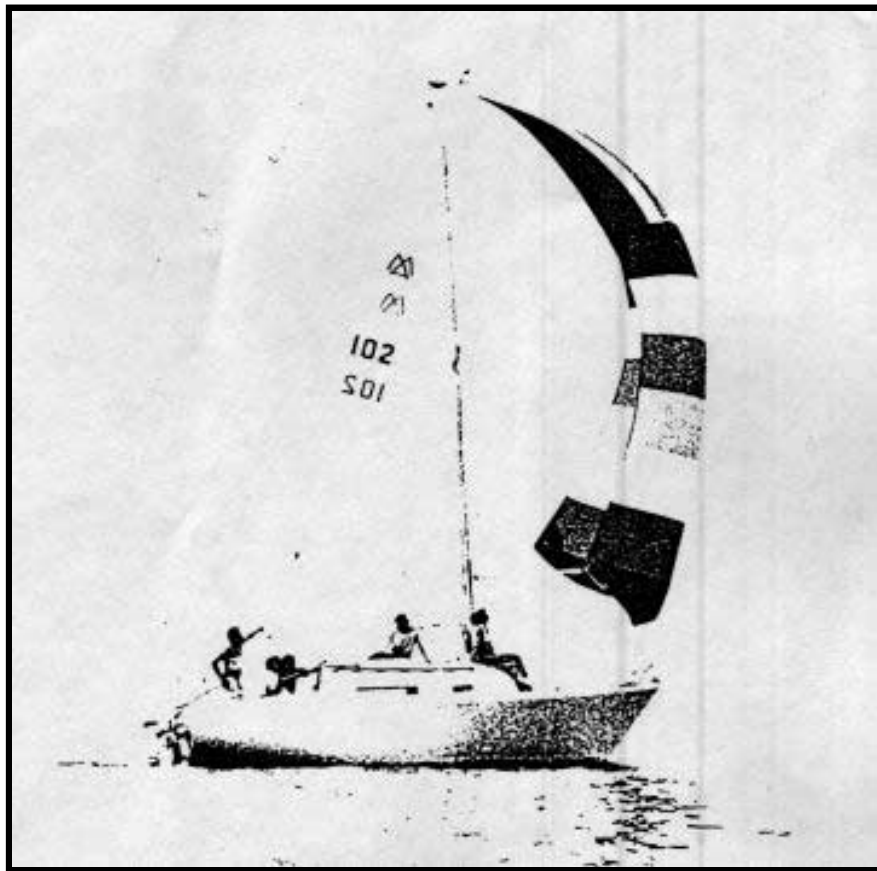

A yacht that's distinctly Ouyang.

# Matilda® 23

## Manufacturers Comments:

The Matilda 23 is a distinctly Ouyang yacht with the innovative interior layout that characterizes the Matilda line. We have incorporated full headroom in this design. This feature is in more demand than ever in a 23 footer, and will find many admirers.

The basic concept is a moderate displacement boat with a high degree of stability for medium to heavy weather sailing. The hull lines show a shape more oriented toward interior volume and stability. By present standards, her 8'2" beam is on the moderate side to help the boat in a steep chop. A very small amount of tumblehome is employed amidships to "reduce deck weight".

The displacement length ratio is 187. This is considered high for her size. The obvious benefit of this feature is increased interior volume. Remember, also, the best way to compare boat prices is dollar per pound of displacement.

In short, the Matilda 23 will offer more usable boat per dollar than her lighter-displacement counterparts.

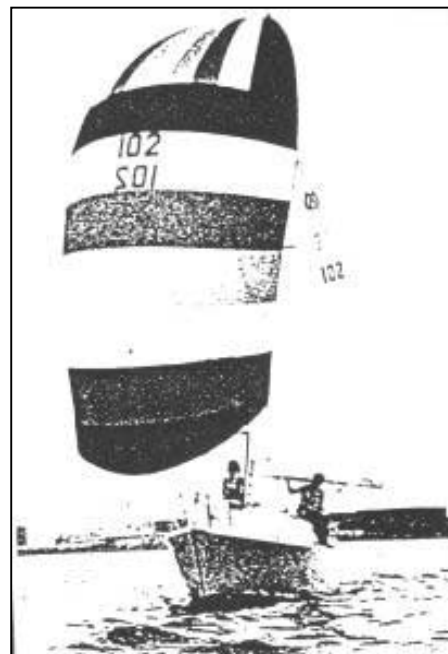

## Topside Layout:

The large foredeck provides ample working room for crew, or for sunbathing. The side decks are wide enough without sacrificing room below deck. The cockpit is large, self-bailing and has a recessed well for the mainsheet traveler.

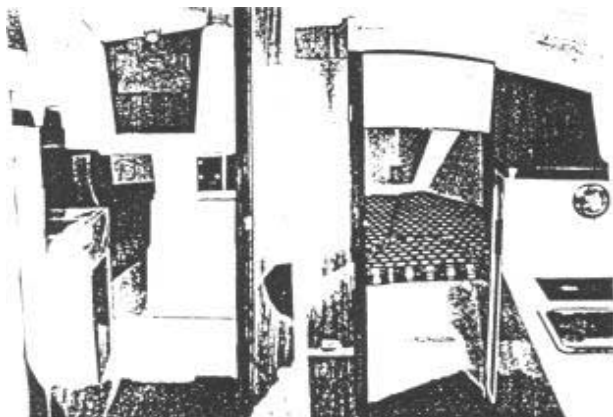

Looking aft

Looking forward

## Accommodations:

Below deck, the Matilda 23 sleeps five. She makes the ideal boat for the serious cruising man or woman. Her 6'0" standing headroom without the necessity of a "pop-top" eliminates potential leaks.

## Washroom:

The fully enclosed head compartment is located to port, and a spacious hanging locker opposite. There is a choice of the standard recirculating chemical head, or a flush thru-hull. A wash basin and water pump behind the head, or an opening window are available as options.

## Dinette:

The Matilda 23 features the very practical bulkhead table arrangement first introduced on our Aloha 28, and then the Aloha 34.

The table arrangement sits four persons comfortably. Also the table could still be set up without disturbing the late sleeper on the settee.

A hinged extension table leaf is available as an option. There is exceptional cabin space with the Matilda 23 table arrangement.

**Construction:**

Hand laid-up fibreglass reinforced hull and deck with balsa core for exceptional stiffness and strength with minimum weight. The hull and deck interior liners give a smooth interior finish and provide insulation against condensation.

Topsides equipment are of the highest specifications: stainless steel, alloy, or non-corrosive materials. Below deck, the elegant interior is finished in Burma Teak, with evidence of craftsmanship at its best throughout.

A full list of standard inventory and accessories are available on separate sheets.

Photographs May Show Options.

All Specifications Show And Described Subject To Change Without Notice Or Obligations.

Matilda & Aloha Are Registered Trademarks Of Ouyang Boat Works Limited In The United States And Canada.

Printed In Canada.

# Matilda 23

**Specifications:**

L.O.A.	23'6"
L.W.L.	18'2"
Beam	8'2"
Draft	24" (bd. up), 5'2" (bd. down)
Displacement	4600 lbs.
Ballast	1750 lbs.
Headroom	6'
Sail Area	Main: 150 sq. ft.
	Working Jib: 120 sq. ft.
	170% Genoa: 135 sq. ft.
	Spinnaker: 500 sq. ft.

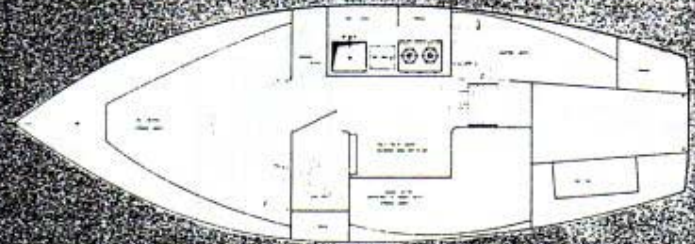
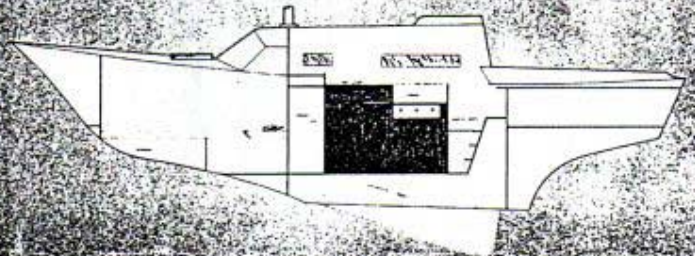

Builders of MATILDA 16, 20, & 23, ALOHA 28, 34  
1636 Charles Street,  
Whitby, Ontario, Canada L1N 1B9  
(416) 668-5511